

EMBROIDERY ON PAPER INSTRUCTIONS

1.



Hoop one layer of cutaway stabilizer and put a small amount of glue in the centre of the hoop.

2.



Press and hold paper on glued area for approximately 30 seconds. Attach hoop to machine and begin sewing.

3.



Sew entire design. **DO NOT CUT ANYTHING UNTIL DESIGN IS COMPLETE.** Remove from hoop and cut desired shape around outside of design.

4.



Turn over and cut excess cutaway from edge.

5.



From back side cut an X from diagonal corners using either a utility blade or scissors.

EMBROIDERY ON PAPER INSTRUCTIONS

6.



Dab a small amount of glue on all four tabs, and fold back.

7.

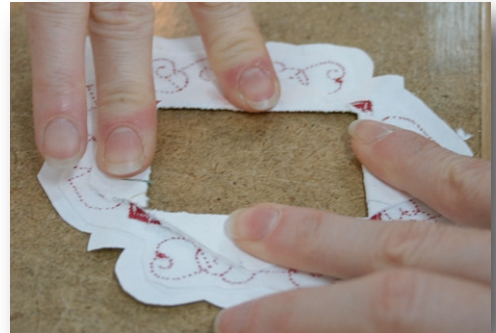

Hold down until glue sets. Design could be placed under a heavy book to flatten and set.

8.



FINISHED!